

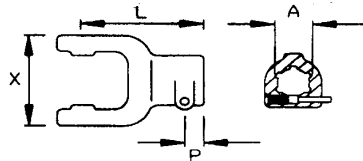

### Quick Disconnect Yoke with Q.D. Pin



Shaft Size		A	X	P	L	Part No.
2100	22 X 54.8	1-1/8"-6	65	16	92	8-010111
		1-3/8"-6				8-010110
		1-3/8"-21				8-010112
2200	23.8 X 61.3	1-1/8"-6	71	18	97	8-010211
		1-3/8"-6				8-010210
		1-3/8"-21				8-010212
WI	27 X 70	1-1/8"-6	80	18	102	8-10311
		1-3/8"-6				8-10310
		1-3/8"-21				8-10312
2300	27 X 74.6	1-1/8"-6	85	18	109	8-010411
		1-3/8"-6				8-010410
		1-3/8"-21				8-010412
2400	32 X 76	1-3/8"-6	89	20	112	8-010510
		1-3/8"-21				8-010512
		1-3/4"-6				8-010513
		1-3/4"-20				8-010517
WII	34 X 90	1-3/8"-6	89	20	112	8-015610
		1-3/8"-21				8-015612
		1-3/4"-6				8-015613
		1-3/4"-20				8-015617
W220	30.2 X 92	1-3/8"-6	106	20	122	8-10610
		1-3/8"-21				8-10612
		1-3/4"-6				8-10613
		1-3/4"-20				8-10617
2500	36 X 89	1-3/8"-6	106	20	122	8-016710
		1-3/8"-21				8-016712
		1-3/4"-6				8-016713
		1-3/4"-20				8-016717
L 8V T 8V	35 X 106.5	1-3/8"-6	117	20	125	8-10810
		1-3/8"-21				8-10812
		1-3/4"-6				8-10813
		1-3/4"-20				8-10817
2600	42 X 104	1-3/8"-6	121	20	126	8-010910
		1-3/8"-21				8-010912
		1-3/4"-6				8-010913
		1-3/4"-20				8-010917