

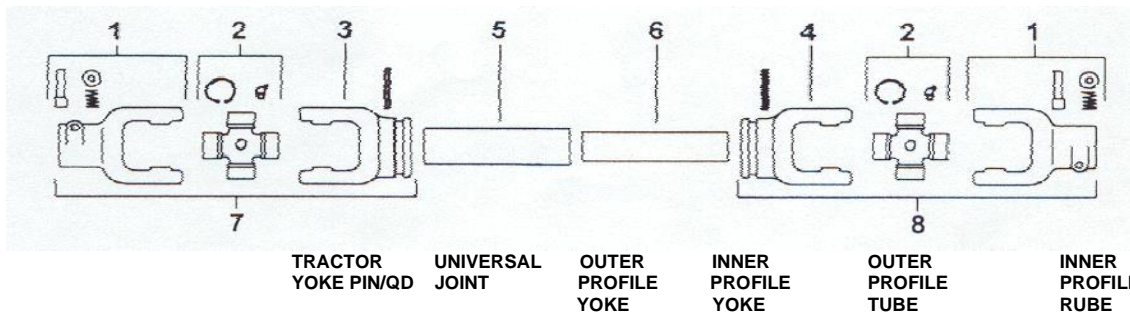





PTO Drive Shafts Components

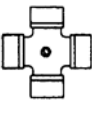

METRIC SERIES		1	2	3	4	5	* 6
							
2100	22 x 54.8	8-2112	1-1001B	8-2120	8-2130	30 X 39 X 2.8 70-2104	23.5 X 31 X 3.6 70-2105
		8-2112	1-1001B	8-51320L	8-51330L	41 X 48 X 3 70-2204	34.5 X 40 X 4 70-2105
2200	23.8 x 61.3	8-2012	1-0221B	8-50220L	8-50230L	30 X 39 X 2.8 70-2104	23.5 X 31 X 3.6 70-2105
		8-2012	1-0221B	8-2220	8-2230	41 X 48 X 3 70-2204	34.5 X 40 X 4 70-2205
2300	27 x 74.6	8-4012	1-0421B	8-2320	8-2330	41 X 48 X 3 70-2204	34.5 X 40 X 4 70-2205
		8-4012	1-0421B	8-54620L	8-54630L	48 X 57.5 X 4 70-2404	39.5 X 49 X 4.5 70-2405
2400	32 x 76	8-2412	2-2421B	8-2420	8-2430	48 X 57.5 X 4 70-2404	39.5 X 49 X 4.5 70-2405
2500	36 X 89	8-2512	3-2521B	8-56720L	8-56730L	48 X 57.5 X 4 70-2404	39.5 X 49 X 4.5 70-2405

Old Style		OUTER TUBE		INNER TUBE			
		YOKE	YOKE	YOKE	YOKE		
W1	27 X 70	8-3012	8-0321B	8-0120	8-0130	41 X 48 X 3 70-2204	34.5 X 40 X 4 70-2205
W11	34 X 90	8-015610	3-025640	8-55620L	8-55630L	48 X 57.5 X 4 70-2404	39.5 X 49 X 4.5 70-2405
W220	30.18 X 92	8-6012	3-0621B	8-50620L	8-50630L	48 X 57.5 X 4 70-2404	39.5 X 49 X 4.5 70-2405
W230	30.2 X 106.5	8-11110 OLD STYLE #7	3-21140	8-51120L	8-51130L	48 X 57.5 X 4 70-2404	39.5 X 49 X 4.5 70-2405
W240	35 X 106.5	8-8012	3-0821B	8-51220L	8-51230L	48 X 57.5 X 4 70-2404	39.5 X 49 X 4.5 70-2405

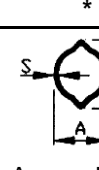
* 5 - 6= Lengths of 59"

PTO Drive Shafts Components

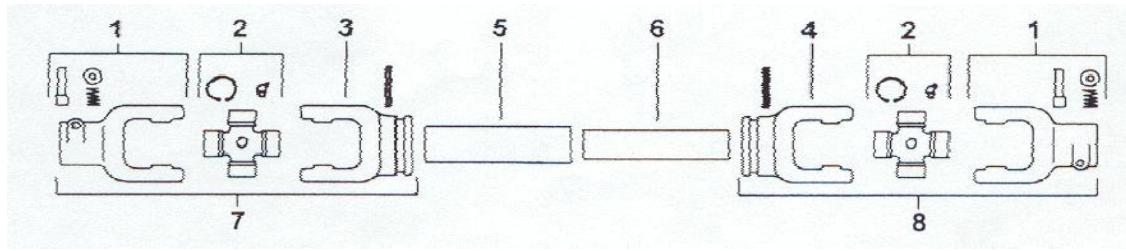

OUTER INNER

SERIES		1	2	3	4	** 5	** 6
		1-3/8"-6				A B S	A B S
2400	32 x 76	8-2412	2-2421B	8-50520T	8-50530T	61 X 47 X 4.5 70-2504	51 X 37 - 70-2505
2500	36 X 89	8-2512	3-2521B	8-2520	8-2530	61 X 47 X 4.5 70-2504	51 X 37 - 70-2505
2600	42 X 104	8-2612	3-2621B	8-2620	8-2630	61 X 47 X 4.5 70-2504	51 X 37 - 70-2505
		8-2612	3-2621B	8-50920T	8-50930T	71.5 X 57.5 X 5 70-60220T	61 X 47 4.5 *70-60120T
						L = 1010	L = 1040
* Hardened Tube							

L56 QD 1-3/8

Old Style

6 SPLINE

W11	34 X 90	8-015610	3-025640	8-55620T	8-55630T	61 X 47 X 4.5 70-2504	51 X 37 - 70-2505
W220	30.18 X 92	8-6012	3-0621B	8-50620T	8-50630T	61 X 47 X 4.5 70-2504	51 X 37 - 70-2505
W230	30.2 X 106.5	8-11110 <small>QD OLD STYLE 7</small>	3-21140	8-51120T	8-51130T	61 X 47 X 4.5 70-2504	51 X 37 - 70-2505
W240	35 X 106.5	8-8012	3-0821B	8-51220T	8-51230T	61 X 47 X 4.5 70-2504	51 X 37 - 70-2505

* 5 - 6= Lengths of 59"

PTO Drive Shafts Components

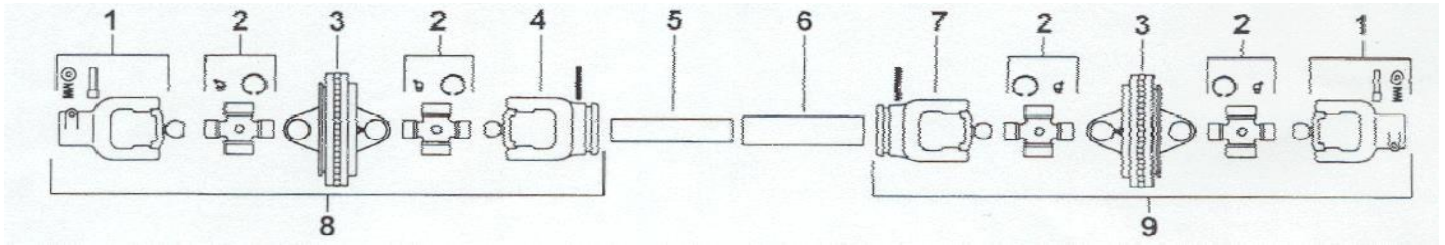

SERIES					1	2	3	4	* 5	* 6	7
	A	B	C	D	1-3/8"-6				 A B S	 A B S	
2280	23.8	61.3	22	80	8-607	3-615	8-622	8-608	34.5 X 40 X 3 70-2205	41 X 48 X 3 70-2204	8-609
2380	27	74.6	23.8	95	8-637	3-621	8-623	8-645	34.5 X 40 X 3 70-2205	41 X 48 X 3 70-2204	8-4020
2380	27	74.6	23.8	95	8-637	3-621	8-623	8-645	39.5 X 49 X 4.5 70-2405	48 X 57.5 X 4 70-2404	8-611
2480	32	76	27	98	8-651	3-635	8-624	8-652	39.5 X 49 X 4.5 70-2405	48 X 57.5 X 4 70-2404	8-653
2580	36	89	32	110	8-763	3-636	8-625	8-661	39.5 X 49 X 4.5 70-2405	48 X 57.5 X 4 70-2404	8-662

Old Style

					1	2	3	4	*5	**6	7
	A	B	C	D	1-3/8"-6			 	 A B	 A B S	
2480	32	76	27	98	8-651	3-635	8-624	8-652E	51 X 37 70-2505	61 X 47 X 4.5 70-2504	8-653E
2580	36	89	32	110	8-763	3-636	8-625	8-661E	51 X 37 70-2505	61 X 47 X 4.5 70-2504	8-662E

* 5 = Rilsan Coated Profile Cutted in fixed lengths of 59"

**6 = Lengths of 59"